

SK Hydrodehnspannfutter - kurzes und schweres Design SK Hydraulic Chuck - Short&Heavy Design	4-6	
SK Hydrodehnspannfutter schlanke Ausführung SK Hydraulic Chuck Slim Line	7	
BT Hydrodehnspannfutter - kurzes und schweres Design BT Hydraulic Chuck - Short&Heavy Design	8-11	
BT Hydrodehnspannfutter schlanke Ausführung BT Hydraulic Chuck Slim Line	12	
F-BT Hydrodehnspannfutter Face Contact F-BTHydraulic Chuck Face Contact	13-14	
HSK Hydrodehnspannfutter HSK Hydraulic Chuck	15-16	
HSK Hydrodehnspannfutter schlanke Ausführung HSK Hydraulic Chuck Slim Line	17	
PSC Hydrodehnspannfutter PSC Hydraulic Chucks	18-19	
Hydrodehn-Aufsteckfräsdorn Hydraulic Shell Mill Holder	20-21	
Hydrodehnspannfutter Radial Einstellbar mit Winkelausrichtung Hydraulic chuck Radially Adjustable with angle adjustment	22	
Hydrodehnspannfutter für Schleifmaschinen Hydraulic Chuck for Grinding Machines	24	
Hydrodehnverlängerung Schlank Hydraulic Chuck Extension	25-26	
ER Hydro-Spannzange ER Hydraulic Collet	27-28	
Reduzierhülsen für Hydrodehnspannfutter Reduction Sleeves for Hydraulic Chucks	29-30	
Hydrodehnspannfutter für Langdrehautomaten Hydraulic Chuck for Swiss Type Lathes	31	

Drehmoment Clamping Torque

Spann-Ø mm Clamping Ø mm	Drehmoment (Nm) Clamping Torque (Nm)	Werkzeugschafttoleranz Tool shaft tolerance
6	15	h6
8	25	h6
10	50	h6
12	110	h6
14	160	h6
16	240	h6
18	350	h6
20	400	h6
25	450	h6
32	500	h6

Leistung Performance

- < 0,003 mm Rundlauf- und Wiederholgenauigkeit
- Feingewuchtet G2,5 25.000 min⁻¹

- < 0.003 mm Runout and Repeatability
- Fine balanced G2.5 25,000 RPM

Werkzeugtoleranz Tool Tolerance

- Für optimale Spannung sind Werkzeuge mit Schafttoleranz h6 empfohlen.
- For optimal clamping power we recommend clamping tools with h6 shaft tolerance.

Temperatur Temperature

- Optimaler Temperaturbereich ist zwischen 20-50 °C. Bei Temperaturen über 80 °C nicht einsetzen.
- Optimal temperature range between 20-50 °C. Do not use with temperatures above 80 °C.

ISO-7388-1 (DIN69871-SK)

G2,5
25 000
min⁻¹ / RPM

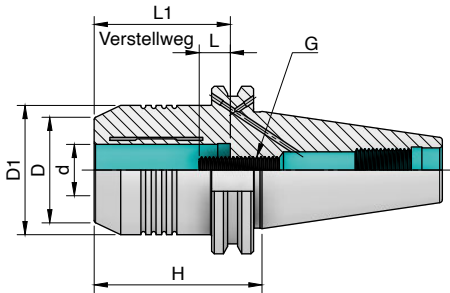

Bestell-Nr. Order No.	Bezeichnung Description	H	d	D	D1	L	L1	G
140.30.020	SK40 H64,5 D20	64.5	20	40	49.5	10	52.5	M8X1.0
150.30.032	SK50 H81 D32	81	32	60	72	10	65	M16X1.0

Hydrodehnspannfutter Kofferset mit Reduzierhülsen
Hydraulic Chuck Kit with Reduction Sleeves

Bestell-Nr. Order No.	Bezeichnung Description	Collet Type	Schlüssel Wrench
140.30.K20	SK40 H64,5 D20 Kofferset	6, 8, 10, 12, 16	4 mm
150.30.K32	SK50 H81 D32 Kofferset	6, 8, 10, 12, 16, 20, 25	5 mm

SK40 ISO-7388-1 (DIN69871-SK)

G2,5
25 000
min⁻¹ / RPM

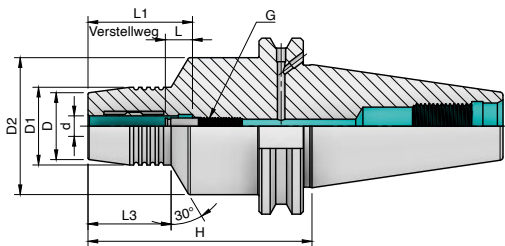

Bestell-Nr. Order No.	Bezeichnung Description	H	d	D	D1	D2	L	L1	L2	G
140.30.106	SK40 H65 D6	65	6	25	28	48	10	37.5	23	M5X0.8
140.30.108	SK40 H65 D8	65	8	27	30	48	10	37.5	23	M6X1.0
140.30.110	SK40 H65 D10	65	10	29	32	48	10	42.5	23	M6X1.0
140.30.112	SK40 H65 D12	65	12	31	34	48	10	47.5	23	M6X1.0
140.30.114	SK40 H75 D14	75	14	33	36	48	10	47.5	30	M6X1.0
140.30.116	SK40 H75 D16	75	16	35	38	48	10	52.5	30	M8X1.0
140.30.118	SK40 H75 D18	75	18	38	41	48	10	52.5	30	M8X1.0
140.30.120	SK40 H75 D20	75	20	40	43	48	10	52.5	30	M8X1.0
140.30.206	SK40 H80,5 D6	80.5	6	25	28	48	10	37.5	44	M5X0.8
140.30.208	SK40 H80,5 D8	80.5	8	27	30	48	10	37.5	44	M6X1.0
140.30.210	SK40 H80,5 D10	80.5	10	29	32	48	10	42.5	44	M6X1.0
140.30.212	SK40 H80,5 D12	80.5	12	31	34	48	10	47.5	44	M6X1.0
140.30.214	SK40 H80,5 D14	80.5	14	33	36	48	10	47.5	44	M6X1.0
140.30.216	SK40 H80,5 D16	80.5	16	35	38	48	10	52.5	30	M8X1.0
140.30.218	SK40 H80,5 D18	80.5	18	38	41	48	10	52.5	30	M8X1.0
140.30.220	SK40 H80,5 D20	80.5	20	40	43	48	10	52.5	48	M8X1.0
140.30.225	SK40 H80,5 D25	80.5	25	53	57	66	10	61	26	M16X1.0
140.30.232	SK40 H80,5 D32	80.5	32	60	63	75	10	65	26	M16X1.0
140.30.306	SK40 H110 D6	110	6	25	28	48	10	37.5	44	M5X0.8
140.30.308	SK40 H110 D8	110	8	27	30	48	10	37.5	44	M6X1.0
140.30.310	SK40 H110 D10	110	10	29	32	48	10	42.5	44	M6X1.0
140.30.312	SK40 H110 D12	110	12	31	34	48	10	47.5	44	M6X1.0
140.30.314	SK40 H110 D14	110	14	33	36	48	10	47.5	44	M6X1.0
140.30.316	SK40 H110 D16	110	16	35	38	48	10	52.5	48	M8X1.0
140.30.318	SK40 H110 D18	110	18	38	41	48	10	52.5	48	M8X1.0
140.30.320	SK40 H110 D20	110	20	40	43	48	10	52.5	48	M8X1.0

SK50 ISO-7388-1 (DIN69871-SK)

G2,5
15 000
min⁻¹ / RPM

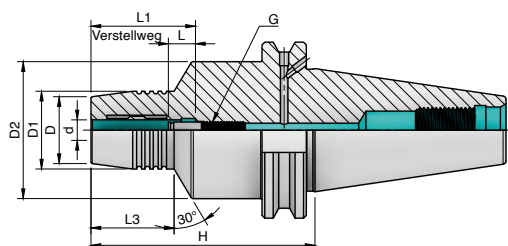

Bestell-Nr. Order No.	Bezeichnung Description	H	d	D	D1	D2	L	L1	L2	G
150.30.106	SK50 H90 D6	90	6	25	28	50	10	37.5	44	M5X0.8
150.30.108	SK50 H90 D8	90	8	27	30	50	10	37.5	44	M6X1.0
150.30.110	SK50 H90 D10	90	10	29	32	50	10	42.5	44	M6X1.0
150.30.112	SK50 H90 D12	90	12	31	34	50	10	47.5	44	M6X1.0
150.30.114	SK50 H90 D14	90	14	33	36	50	10	47.5	47	M6X1.0
150.30.116	SK50 H90 D16	90	16	35	38	50	10	52.5	48	M8X1.0
150.30.118	SK50 H90 D18	90	18	38	41	50	10	52.5	48	M8X1.0
150.30.120	SK50 H90 D20	90	20	40	43	50	10	52.5	48	M8X1.0
150.30.125	SK50 H105 D25	105	25	53	57	-	10	61	85.9	M16X1.0
150.30.132	SK50 H115 D32	115	32	58	63	-	10	65	95.9	M16X1.0
150.30.306	SK50 H140 D6	140	6	25	28	50	10	37.5	44	M5X0.8
150.30.308	SK50 H140 D8	140	8	27	30	50	10	37.5	44	M6X1.0
150.30.310	SK50 H140 D10	140	10	29	32	50	10	42.5	44	M6X1.0
150.30.312	SK50 H140 D12	140	12	31	34	50	10	47.5	44	M6X1.0
150.30.314	SK50 H140 D14	140	14	33	36	50	10	47.5	47	M6X1.0
150.30.316	SK50 H140 D16	140	16	35	38	50	10	52.5	48	M8X1.0
150.30.318	SK50 H140 D18	140	18	38	41	50	10	52.5	48	M8X1.0
150.30.320	SK50 H140 D20	140	20	40	43	50	10	52.5	48	M8X1.0
150.30.325	SK50 H140 D25	140	25	53	57	-	10	61	120.9	M16X1.0
150.30.332	SK50 H140 D32	140	32	58	63	-	10	65	120.9	M16X1.0

SK40 ISO-7388-1 (DIN69871-SK)

G2,5
25 000
min⁻¹ / RPM

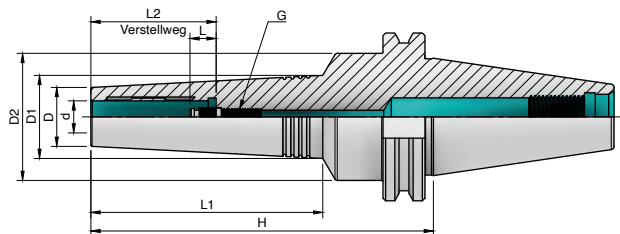

Bestell-Nr. Order No.	Bezeichnung Description	H	d	D	D1	D2	L	L1	L2	G
140.30S.306	SK40 H130 D6	130	6	16	25.1	48	10	87	37.5	M5X0.8
140.30S.308	SK40 H130 D8	130	8	18	27.1	48	10	87	37.5	M6X1.0
140.30S.310	SK40 H130 D10	130	10	20	29.2	48	10	88	42.5	M6X1.0
140.30S.312	SK40 H130 D12	130	12	22	31.3	48	10	88	47.5	M6X1.0
140.30S.314	SK40 H130 D14	130	14	24	33.3	48	10	89	47.5	M6X1.0
140.30S.316	SK40 H130 D16	130	16	26	35.3	48	10	89	52.5	M8X1.0
140.30S.318	SK40 H130 D18	130	18	29	38.4	48	10	90	52.5	M8X1.0
140.30S.320	SK40 H130 D20	130	20	31	40.4	48	10	90	52.5	M8X1.0

BT30 ISO-7388-2 / JIS B 6339

G2,5
 25 000
 min⁻¹ / RPM

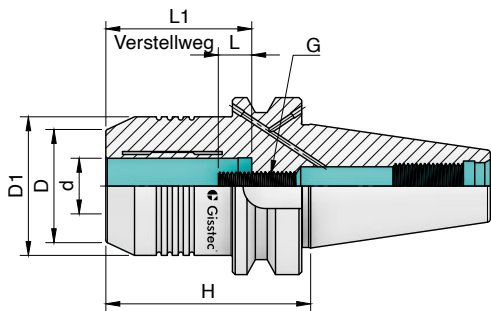

Bestell-Nr. Order No.	Bezeichnung Description	H	d	D	D1	L	L1	G
330.30.020	BT30 H85 D20	85	20	40	44	10	52.5	M8X1.0
340.30.020	BT40 H72,5 D20	72.5	20	40	49.5	10	52.5	M8X1.0
350.30.032	BT50 H90 D32	90	32	60	72	10	65	M16X1.0

BT Hydrodehnspannfutter Kofferset mit Reduzierhülsen
 BT Hydraulic Chuck Kit with Reduction Sleeves

Bestell-Nr. Order No.	Bezeichnung Description	Reduzierhülsen Reduction Sleeves	Schlüssel Wrench
330.30.K20	BT30 H85 D20 Kofferset	6, 8, 10, 12, 16	4 mm
340.30.K20	BT40 H72,5 D20 Kofferset	6, 8, 10, 12, 16	4 mm
350.30.K32	BT50 H90 D32 Kofferset	6, 8, 10, 12, 16, 20, 25	5 mm

BT30 ISO-7388-2 / JIS B 6339

G2,5
25 000
min⁻¹ / RPM

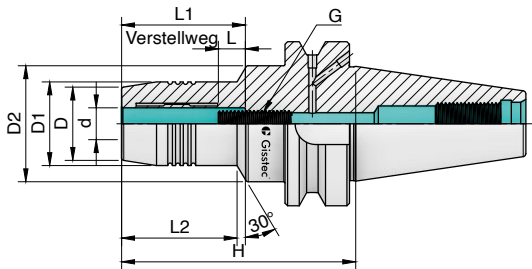

Bestell-Nr. Order No.	Bezeichnung Description	H	d	D	D1	D2	L	L1	L2	G
330.30.103	BT30 H70 D3	70	3	21	24	45	-	24	30	-
330.30.104	BT30 H70 D4	70	4	22	25	45	-	28	30	-
330.30.105	BT30 H70 D5	70	5	23	26	45	-	32	30	-
330.30.106	BT30 H70 D6	70	6	25	28	45	10	37.5	28.5	M5X0.8
330.30.108	BT30 H70 D8	70	8	27	30	45	10	37.5	28.5	M6X1.0
330.30.110	BT30 H75 D10	75	10	29	32	45	10	42.5	38	M6X1.0
330.30.112	BT30 H75 D12	75	12	31	34	45	10	47.5	36	M6X1.0
330.30.114	BT30 H85 D14	85	14	33	36	45	10	47.5	44	M6X1.0
330.30.116	BT30 H90 D16	90	16	35	38	45	10	52.5	48	M8X1.0
330.30.118	BT30 H90 D18	90	18	38	41	45	10	52.5	48	M8X1.0
330.30.120	BT30 H90 D20	90	20	40	43	-	10	52.5	-	M8X1.0

BT Hydrodehnspannfutter Schlanke Ausführung
BT Hydraulic Chuck Slim Line

G2,5
25 000
min⁻¹ / RPM

BT30 ISO-7388-2 / JIS B 6339

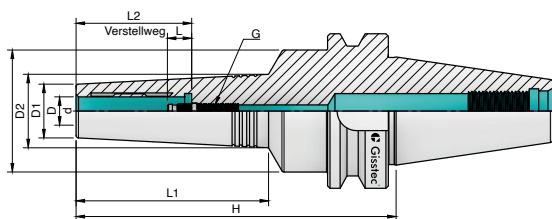

Bestell-Nr. Order No.	Bezeichnung Description	H	d	D	D1	D2	L	L1	L2	G
330.30S.306	BT30 H120 D6	120	6	16	23.9	45	10	75	37.5	M5X0.8
330.30S.308	BT30 H120 D8	120	8	18	25.9	45	10	75	37.5	M6X1.0
330.30S.310	BT30 H120 D10	120	10	20	28	45	10	76	42.5	M6X1.0
330.30S.312	BT30 H120 D12	120	12	22	30	45	10	76	47.5	M6X1.0
330.30S.314	BT30 H120 D14	120	14	24	32.1	45	10	77	47.5	M6X1.0
330.30S.316	BT30 H120 D16	120	16	26	34.1	45	10	77	52.5	M6X1.0
330.30S.318	BT30 H120 D18	120	18	29	37.2	45	10	78	52.5	M6X1.0
330.30S.320	BT30 H120 D20	120	20	31	39.3	45	10	78	52.5	M6X1.0

BT40 ISO-7388-2 / JIS B 6339

G2,5
25 000
min⁻¹ / RPM

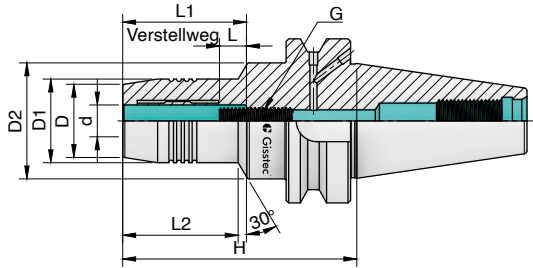

Bestell-Nr. Order No.	Bezeichnung Description	H	d	D	D1	D2	L	L1	L2	G
340.30.106	BT40 H65 D6	65	6	25	28	50	10	37.5	23	M5X0.8
340.30.108	BT40 H65 D8	65	8	27	30	50	10	37.5	23	M6X1.0
340.30.110	BT40 H65 D10	65	10	29	32	50	10	42.5	23	M6X1.0
340.30.112	BT40 H65 D12	65	12	31	34	50	10	47.5	23	M6X1.0
340.30.114	BT40 H65 D14	65	14	33	36	50	10	47.5	23	M6X1.0
340.30.116	BT40 H65 D16	65	16	35	38	50	10	52.5	23	M8X1.0
340.30.118	BT40 H75 D18	75	18	38	41	50	10	52.5	30	M8X1.0
340.30.120	BT40 H75 D20	75	20	40	43	50	10	52.5	30	M8X1.0
340.30.206	BT40 H90 D6	90	6	25	28	50	10	37.5	44	M5X0.8
340.30.208	BT40 H90 D8	90	8	27	30	50	10	37.5	39	M6X1.0
340.30.210	BT40 H90 D10	90	10	29	32	50	10	42.5	44	M6X1.0
340.30.212	BT40 H90 D12	90	12	31	34	50	10	47.5	44	M6X1.0
340.30.214	BT40 H90 D14	90	14	33	36	50	10	47.5	44	M6X1.0
340.30.216	BT40 H90 D16	90	16	35	38	50	10	52.5	48	M8X1.0
340.30.218	BT40 H90 D18	90	18	38	41	50	10	52.5	48	M8X1.0
340.30.220	BT40 H90 D20	90	20	40	43	50	10	52.5	48	M8X1.0
340.30.225	BT40 H100 D25	100	25	53	57	-	10	61	73	M16X1.0
340.30.232	BT40 H105 D32	105	32	53	57	61	10	65	45	M16X1.0
340.30.306	BT40 H140 D6	140	6	25	28	50	10	37.5	44	M5X0.8
340.30.308	BT40 H140 D8	140	8	27	30	50	10	37.5	44	M6X1.0
340.30.310	BT40 H140 D10	140	10	29	32	50	10	42.5	44	M6X1.0
340.30.312	BT40 H140 D12	140	12	31	34	50	10	47.5	44	M6X1.0
340.30.314	BT40 H140 D14	140	14	33	36	50	10	47.5	44	M6X1.0
340.30.316	BT40 H140 D16	140	16	35	38	50	10	52.5	48	M8X1.0
340.30.318	BT40 H140 D18	140	18	38	41	50	10	52.5	48	M8X1.0
340.30.320	BT40 H140 D20	140	20	40	43	50	10	52.5	48	M8X1.0
340.30.325	BT40 H135 D25	135	25	53	57	-	10	61	108	M16X1.0
340.30.332	BT40 H135 D32	135	32	53	57	61	10	65	78	M16X1.0

BT50 ISO-7388-2 / JIS B 6339

G2,5
15 000
min⁻¹ / RPM

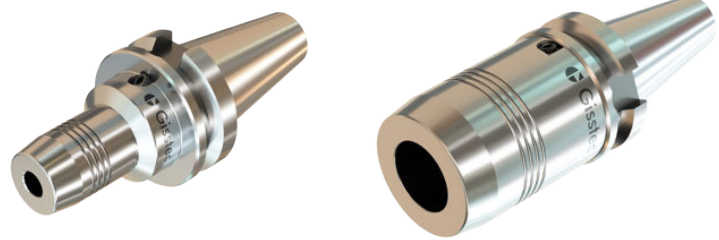
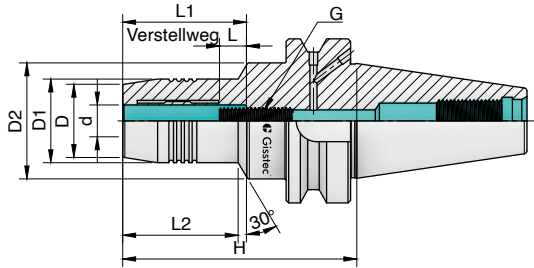

Bestell-Nr. Order No.	Bezeichnung Description	H	d	D	D1	D2	L	L1	L2	G
350.30.106	BT50 H90 D6	90	6	25	28	50	10	37.5	32	M5X0.8
350.30.108	BT50 H90 D8	90	8	27	30	50	10	37.5	32	M6X1.0
350.30.110	BT50 H90 D10	90	10	29	32	50	10	42.5	32	M6X1.0
350.30.112	BT50 H90 D12	90	12	31	34	50	10	47.5	32	M6X1.0
350.30.114	BT50 H90 D14	90	14	33	36	50	10	47.5	32	M6X1.0
350.30.116	BT50 H90 D16	90	16	35	38	50	10	52.5	32	M8X1.0
350.30.118	BT50 H90 D18	90	18	38	41	50	10	52.5	32	M8X1.0
350.30.120	BT50 H90 D20	90	20	40	43	50	10	52.5	32	M8X1.0
350.30.125	BT50 H105 D25	105	25	53	57	-	10	61	67	M16X1.0
350.30.132	BT50 H115 D32	115	32	58	63	-	10	65	77	M16X1.0
350.30.206	BT50 H120 D6	120	6	25	28	50	10	37.5	44	M5X0.8
350.30.208	BT50 H120 D8	120	8	27	30	50	10	37.5	40	M6X1.0
350.30.210	BT50 H120 D10	120	10	29	32	50	10	42.5	44	M6X1.0
350.30.212	BT50 H120 D12	120	12	31	34	50	10	47.5	44	M6X1.0
350.30.214	BT50 H120 D14	120	14	33	36	50	10	47.5	44	M6X1.0
350.30.216	BT50 H120 D16	120	16	35	38	50	10	52.5	48	M8X1.0
350.30.218	BT50 H120 D18	120	18	38	41	50	10	52.5	48	M8X1.0
350.30.220	BT50 H120 D20	120	20	40	43	50	10	52.5	48	M8X1.0
350.30.306	BT50 H140 D6	140	6	25	28	50	10	37.5	44	M5X0.8
350.30.308	BT50 H140 D8	140	8	27	30	50	10	37.5	44	M6X1.0
350.30.310	BT50 H140 D10	140	10	29	32	50	10	42.5	44	M6X1.0
350.30.312	BT50 H140 D12	140	12	31	34	50	10	47.5	44	M6X1.0
350.30.314	BT50 H140 D14	140	14	33	36	50	10	47.5	44	M6X1.0
350.30.316	BT50 H140 D16	140	16	35	38	50	10	52.5	48	M8X1.0
350.30.318	BT50 H140 D18	140	18	38	41	50	10	52.5	48	M8X1.0
350.30.320	BT50 H140 D20	140	20	40	43	50	10	52.5	48	M8X1.0
350.30.325	BT50 H150 D25	150	25	53	57	-	10	61	112	M16X1.0
350.30.332	BT50 H150 D32	150	32	58	63	-	10	65	112	M16X1.0

BT40 ISO-7388-2 / JIS B 6339

G2,5
25 000
min⁻¹ / RPM

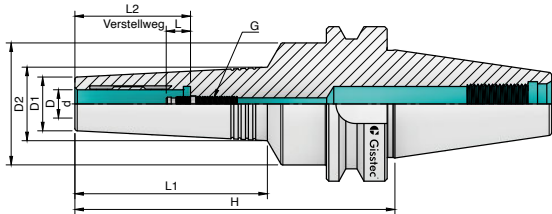

Bestell-Nr. Order No.	Bezeichnung Description	H	d	D	D1	D2	L	L1	L2	G
340.30S.306	BT40 H130 D6	130	6	16	24.3	50	10	78	37.5	M5X0.8
340.30S.308	BT40 H130 D8	130	8	18	26.2	50	10	78	37.5	M6X1.0
340.30S.310	BT40 H130 D10	130	10	20	28.3	50	10	79	42.5	M6X1.0
340.30S.312	BT40 H130 D12	130	12	22	30.4	50	10	79	47.5	M6X1.0
340.30S.314	BT40 H130 D14	130	14	24	32.4	50	10	80	47.5	M6X1.0
340.30S.316	BT40 H130 D16	130	16	26	34.4	50	10	80	52.5	M8X1.0
340.30S.318	BT40 H130 D18	130	18	29	37.5	50	10	81	52.5	M8X1.0
340.30S.320	BT40 H130 D20	130	20	31	39.5	50	10	81	52.5	M8X1.0

F-BT ISO-7388-2 / JIS B 6339

G2,5
25 000
min⁻¹ / RPM

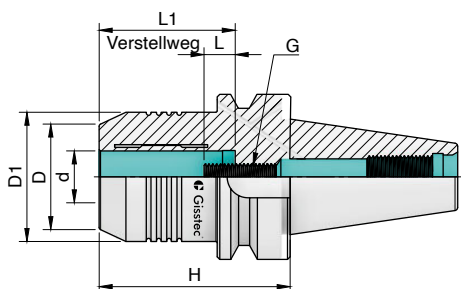

Bestell-Nr. Order No.	Bezeichnung Description	H	d	D	D1	L	L1	G
330.F30.120	F-BT30 H85 D20	85	20	40	44	10	52.5	M8X1.0
340.F30.120	F-BT40 H72,5 D20	72.5	20	40	49.5	10	52.5	M8X1.0
350.F30.132	F-BT50 H90 D32	90	32	60	72	10	65	M16X1.0

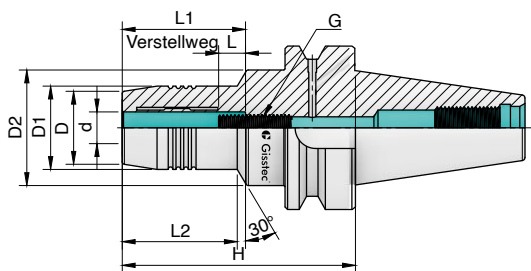

Bestell-Nr. Order No.	Bezeichnung Description	H	d	D	D1	D2	L	L1	L2	G
340.F30.206	F-BT40 H90 D6	90	6	25	28	50	10	37.5	44	M5X0.8
340.F30.208	F-BT40 H90 D8	90	8	27	30	50	10	37.5	39	M6X1.0
340.F30.210	F-BT40 H90 D10	90	10	29	32	50	10	42.5	44	M6X1.0
340.F30.212	F-BT40 H90 D12	90	12	31	34	50	10	47.5	44	M6X1.0
340.F30.214	F-BT40 H90 D14	90	14	33	36	50	10	47.5	44	M6X1.0
340.F30.216	F-BT40 H90 D16	90	16	35	38	50	10	52.5	48	M8X1.0
340.F30.218	F-BT40 H90 D18	90	18	38	41	50	10	52.5	48	M8X1.0
340.F30.220	F-BT40 H90 D20	90	20	40	43	50	10	52.5	48	M8X1.0
340.F30.225	F-BT40 H100 D25	100	25	53	57	-	10	61	73	M16X1.0
340.F30.232	F-BT40 H105 D32	105	32	53	57	61	10	65	45	M16X1.0
340.F30.306	F-BT40 H140 D6	140	6	25	28	50	10	37.5	44	M5X0.8
340.F30.308	F-BT40 H140 D8	140	8	27	30	50	10	37.5	44	M6X1.0
340.F30.310	F-BT40 H140 D10	140	10	29	32	50	10	42.5	44	M6X1.0
340.F30.312	F-BT40 H140 D12	140	12	31	34	50	10	47.5	44	M6X1.0
340.F30.314	F-BT40 H140 D14	140	14	33	36	50	10	47.5	44	M6X1.0
340.F30.316	F-BT40 H140 D16	140	16	35	38	50	10	52.5	48	M8X1.0
340.F30.318	F-BT40 H140 D18	140	18	38	41	50	10	52.5	48	M8X1.0
340.F30.320	F-BT40 H140 D20	140	20	40	43	50	10	52.5	48	M8X1.0
340.F30.325	F-BT40 H135 D25	135	25	53	57	-	10	61	108	M16X1.0
340.F30.332	F-BT40 H135 D32	135	32	53	57	61	10	65	78	M16X1.0

F-BT50 ISO-7388-2 / JIS B 6339

G2,5
15 000
min⁻¹ / RPM

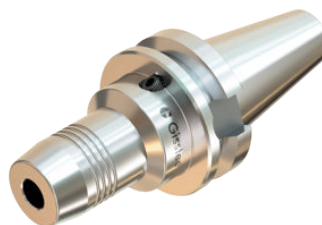
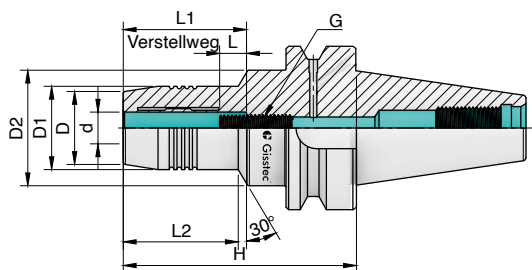

Bestell-Nr. Order No.	Bezeichnung Description	H	d	D	D1	D2	L	L1	L2	G
350.F30.106	F-BT50 6 x 90	90	6	25	28	50	10	37.5	32	M5X0.8
350.F30.108	F-BT50 8 x 90	90	8	27	30	50	10	37.5	32	M6X1.0
350.F30.110	F-BT50 10 x 90	90	10	29	32	50	10	42.5	32	M6X1.0
350.F30.112	F-BT50 12 x 90	90	12	31	34	50	10	47.5	32	M6X1.0
350.F30.114	F-BT50 14 x 90	90	14	33	36	50	10	47.5	32	M6X1.0
350.F30.116	F-BT50 16 x 90	90	16	35	38	50	10	52.5	32	M8X1.0
350.F30.118	F-BT50 18 x 90	90	18	38	41	50	10	52.5	32	M8X1.0
350.F30.120	F-BT50 20 x 90	90	20	40	43	50	10	52.5	32	M8X1.0
350.F30.125	F-BT50 25 x 105	105	25	53	57	-	10	61	67	M16X1.0
350.F30.132	F-BT50 32 x 115	115	32	58	63	-	10	65	77	M16X1.0
350.F30.306	F-BT50 H140 D6	140	6	25	28	50	10	37.5	44	M5X0.8
350.F30.308	F-BT50 H140 D8	140	8	27	30	50	10	37.5	44	M6X1.0
350.F30.310	F-BT50 H140 D10	140	10	29	32	50	10	42.5	44	M6X1.0
350.F30.312	F-BT50 H140 D12	140	12	31	34	50	10	47.5	44	M6X1.0
350.F30.314	F-BT50 H140 D14	140	14	33	36	50	10	47.5	44	M6X1.0
350.F30.316	F-BT50 H140 D16	140	16	35	38	50	10	52.5	48	M8X1.0
350.F30.318	F-BT50 H140 D18	140	18	38	41	50	10	52.5	48	M8X1.0
350.F30.320	F-BT50 H140 D20	140	20	40	43	50	10	52.5	48	M8X1.0
350.F30.325	F-BT50 H150 D25	150	25	53	57	-	10	61	112	M16X1.0
350.F30.332	F-BT50 H150 D32	150	32	58	63	-	10	65	112	M16X1.0

12164-1 (DIN69893 HSK-A)

G2,5
25 000
min⁻¹ / RPM

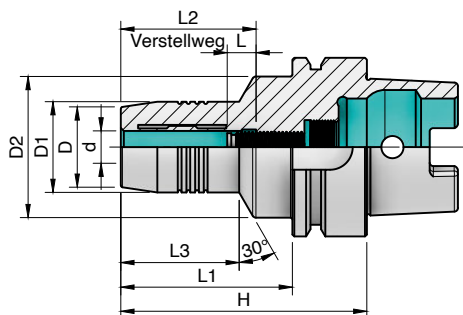

Bestell-Nr. Order No.	Bezeichnung Description	H	d	D	D1	D2	L	L1	L2	L3	G
40A.30.106	HSK40A H70 D6	70	6	25	28	34	10	50	37.5	28.5	M5X0.8
40A.30.108	HSK40A H70 D8	70	8	27	30	34	10	50	37.5	28.5	M5X0.8
40A.30.110	HSK40A H75 D10	75	10	29	32	34	10	55	42.5	34	M5X0.8
40A.30.112	HSK40A H85 D12	85	12	31	34	-	10	65	47.5	-	M5X0.8
50A.30.106	HSK50A H70 D6	70	6	25	28	40	10	44	37.5	28.5	M5X0.8
50A.30.108	HSK50A H70 D8	70	8	27	30	40	10	44	37.5	28.5	M6X1.0
50A.30.110	HSK50A H80 D10	80	10	29	32	40	10	54	42.5	34	M6X1.0
50A.30.112	HSK50A H85 D12	85	12	31	34	40	10	59	47.5	44	M6X1.0
50A.30.114	HSK50A H85 D14	85	14	33	36	40	10	59	47.5	44	M6X1.0
50A.30.116	HSK50A H90 D16	90	16	35	38	41	10	64	52.5	44	M6X1.0
50A.30.118	HSK50A H90 D18	90	18	38	41	-	10	64	52.5	-	M6X1.0
50A.30.120	HSK50A H90 D20	90	20	40	44	-	10	64	52.5	-	M6X1.0
63A.30.106	HSK63A H70 D6	70	6	25	28	50	10	44	37.5	24	M5X0.8
63A.30.108	HSK63A H70 D8	70	8	27	30	50	10	44	37.5	24	M6X1.0
63A.30.110	HSK63A H80 D10	80	10	29	32	50	10	54	42.5	35	M6X1.0
63A.30.112	HSK63A H85 D12	85	12	31	34	50	10	59	47.5	40	M6X1.0
63A.30.114	HSK63A H85 D14	85	14	33	36	50	10	59	47.5	40	M6X1.0
63A.30.116	HSK63A H90 D16	90	16	35	38	50	10	64	52.5	46	M8X1.0
63A.30.118	HSK63A H90 D18	90	18	38	41	50	10	64	52.5	47	M8X1.0
63A.30.120	HSK63A H90 D20	90	20	40	43	50	10	64	52.5	48	M8X1.0
63A.30.125	HSK63A H120 D25	120	25	53	57	63	10	94	61	59	M16X1.0
63A.30.132	HSK63A H125 D32	125	32	58	63	-	10	99	65	-	M16X1.0
100A.30.106	HSK100A H75 D6	75	6	25	28	54	10	46	37.5	26	M5X0.8
100A.30.108	HSK100A H75 D8	75	8	27	30	54	10	46	37.5	26	M6X1.0
100A.30.110	HSK100A H90 D10	90	10	29	32	50	10	61	42.5	42	M6X1.0
100A.30.112	HSK100A H95 D12	95	12	31	34	50	10	66	47.5	47	M6X1.0
100A.30.114	HSK100A H95 D14	95	14	33	36	50	10	66	47.5	47	M6X1.0
100A.30.116	HSK100A H100 D16	100	16	35	38	50	10	71	52.5	53	M8X1.0
100A.30.118	HSK100A H100 D18	100	18	38	41	50	10	71	52.5	53	M8X1.0
100A.30.120	HSK100A H105 D20	105	20	40	43	50	10	76	52.5	59	M8X1.0
100A.30.125	HSK100A H110 D25	110	25	53	57	63	10	81	61	62	M8X1.0
100A.30.132	HSK100A H110 D32	110	32	58	63	75	10	81	65	62	M8X1.0

12164-1 (DIN69893 HSK-A)

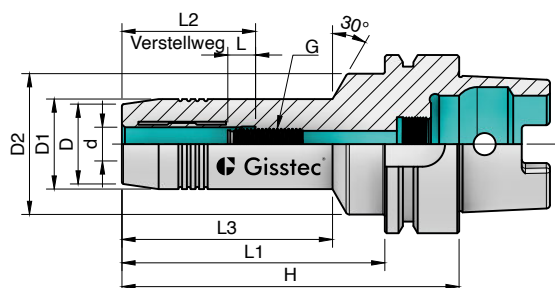

G2,5
25 000
min⁻¹ / RPM

Bestell-Nr. Order No.	Bezeichnung Description	H	d	D	D1	D2	L	L1	L2	L3	G
63A.30.406	HSK63A H150 D6	150	6	25	28	50	10	124	37.5	103	M5X0.8
63A.30.408	HSK63A H150 D8	150	8	27	30	50	10	124	37.5	104	M6X1.0
63A.30.410	HSK63A H150 D10	150	10	29	32	50	10	124	42.5	104	M6X1.0
63A.30.412	HSK63A H150 D12	150	12	31	34	50	10	124	47.5	105	M6X1.0
63A.30.414	HSK63A H150 D14	150	14	33	36	50	10	124	47.5	105	M6X1.0
63A.30.416	HSK63A H150 D16	150	16	35	38	50	10	124	52.5	106	M8X1.0
63A.30.418	HSK63A H150 D18	150	18	38	41	50	10	124	52.5	107	M8X1.0
63A.30.420	HSK63A H150 D20	150	20	40	43	50	10	124	52.5	108	M8X1.0
63A.30.506	HSK63A H200 D6	200	6	25	28	50	10	174	37.5	103	M5X0.8
63A.30.508	HSK63A H200 D8	200	8	27	30	50	10	174	37.5	104	M6X1.0
63A.30.510	HSK63A H200 D10	200	10	29	32	50	10	174	42.5	104	M6X1.0
63A.30.512	HSK63A H200 D12	200	12	31	34	50	10	174	47.5	105	M6X1.0
63A.30.514	HSK63A H200 D14	200	14	33	36	50	10	174	47.5	105	M6X1.0
63A.30.516	HSK63A H200 D16	200	16	35	38	50	10	174	52.5	106	M8X1.0
63A.30.518	HSK63A H200 D18	200	18	38	41	50	10	174	52.5	107	M8X1.0
63A.30.520	HSK63A H200 D20	200	20	40	43	50	10	174	52.5	108	M8X1.0

HSK Hydrodehnspannfutter Kofferset mit Reduzierhülsen
HSK Hydraulic Chuck Kit with Reduction Sleeves

Bestell-Nr. Order No.	Bezeichnung Description	Reduzierhülsen Reduction Sleeves	Schlüssel Wrench
63A.30.K20	HSK63A H90 D20 Kofferset	6, 8, 10, 12, 16	4mm

12164-1 (DIN69893 HSK-A)

G2,5
 25 000
 min⁻¹ / RPM

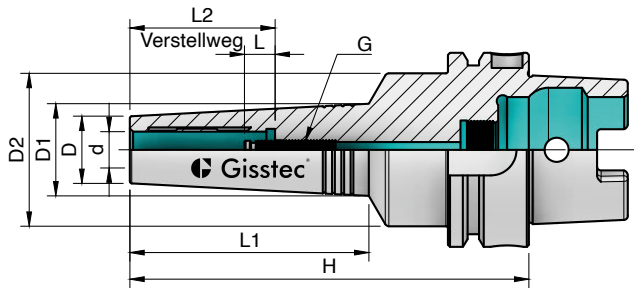

Bestell-Nr. Order No.	Bezeichnung Description	H	d	D	D1	D2	L	L1	L2	G
63A.30S.306	HSK63A H130 D6	130	6	16	24.1	50	10	77	37.5	M5X0.8
63A.30S.308	HSK63A H130 D8	130	8	18	26.1	50	10	77	37.5	M6X1.0
63A.30S.310	HSK63A H130 D10	130	10	20	28.2	50	10	78	42.5	M6X1.0
63A.30S.312	HSK63A H130 D12	130	12	22	30.2	50	10	78	47.5	M6X1.0
63A.30S.314	HSK63A H130 D14	130	14	24	32.3	50	10	79	47.5	M6X1.0
63A.30S.316	HSK63A H130 D16	130	16	26	34.3	50	10	79	52.5	M8X1.0
63A.30S.318	HSK63A H130 D18	130	18	29	37.4	50	10	80	52.5	M8X1.0
63A.30S.320	HSK63A H130 D20	130	20	31	39.4	50	10	80	52.5	M8X1.0

12164-1 (DIN69893 HSK-C)

G2,5
25 000
min⁻¹ / RPM

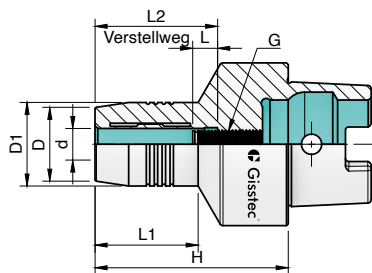

Bestell-Nr. Order No.	Bezeichnung Description	H	d	D	D1	L	L1	L2	G
40C.30.106	HSK40C H60 D6	60	6	25	28	10	35	37.5	M5X0.8
40C.30.108	HSK40C H60 D8	60	8	27	30	10	36	37.5	M5X0.8
40C.30.110	HSK40C H65 D10	65	10	29	32	10	41	42.5	M5X0.8
40C.30.112	HSK40C H70 D12	70	12	31	34	10	47	47.5	M5X0.8
50C.30.106	HSK50C H60 D6	60	6	25	28	10	30	37.5	M5X0.8
50C.30.108	HSK50C H60 D8	60	8	27	30	10	30	37.5	M6X1.0
50C.30.110	HSK50C H65 D10	65	10	29	32	10	35	42.5	M6X1.0
50C.30.112	HSK50C H75 D12	75	12	31	34	10	44	47.5	M6X1.0
50C.30.114	HSK50C H75 D14	75	14	33	36	10	46	47.5	M6X1.0
50C.30.116	HSK50C H80 D16	80	16	35	38	10	51	52.5	M6X1.0
50C.30.118	HSK50C H80 D18	80	18	38	41	10	51	52.5	M6X1.0
50C.30.120	HSK50C H80 D20	80	20	40	43	10	52	52.5	M6X1.0

12164-1 (DIN69893 HSK-E)

G2,5
25 000
min⁻¹ / RPM

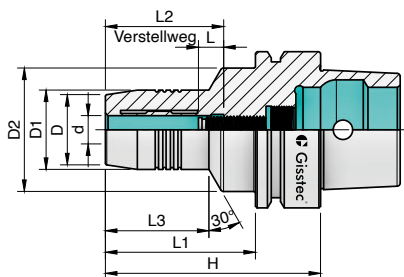

Bestell-Nr. Order No.	Bezeichnung Description	H	d	D	D1	D2	L	L1	L2	L3	G
40E.30.106	HSK40E H75 D6	75	6	25	28	34	10	55	37.5	28	M5X0.8
40E.30.108	HSK40E H70 D8	70	8	27	30	34	10	50	37.5	28	M5X0.8
40E.30.110	HSK40E H75 D10	75	10	29	32	34	10	55	42.5	34	M5X0.8
40E.30.112	HSK40E H85 D12	85	12	31	34	-	10	65	47.5	-	M5X0.8
50E.30.106	HSK50E H70 D6	70	6	26	28	40	10	44	37.5	28	M5X0.8
50E.30.108	HSK50E H70 D8	70	8	28	30	40	10	44	37.5	28	M5X0.8
50E.30.110	HSK50E H80 D10	80	10	29	32	40	10	54	42.5	34	M6X1.0
50E.30.112	HSK50E H85 D12	85	12	31	34	40	10	59	47.5	44	M6X1.0
50E.30.116	HSK50E H90 D16	90	16	35	38	60	10	64	52.5	45	M6X1.0
50E.30.120	HSK50E H90 D20	90	20	40	42	-	10	64	52.5	-	M6X1.0

ISO 26623-1 Polygonschaft (PSC)

G2,5
25 000
min⁻¹ / RPM

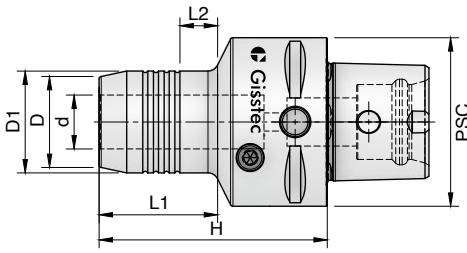

Bestell-Nr. Order No.	Abmessungen Dimensions	PSC	H	d	D1	D2	L1	L2	L3	G
GC40.30.112	C40	40	70	12	32	26	35	10	47	M8x1
GC40.30.120	C40	40	90	20	42	42	45	10	52	M10x1
GC50.30.112	C50	50	75	12	32	26	35	10	47	M8x1
GC50.30.120	C50	50	85	20	42	42	45	10	52	M10x1
GC63.30.112	C63	63	80	12	32	26	35	10	47	M8x1
GC63.30.120	C63	63	85	20	42	42	45	10	52	M10x1
GC63.30.132	C63	63	100	32	26	34	45	10	37	M12x1

MK - Hydrodehnspannfutter
Hydraulic Chuck Morse Taper

DIN 228 MK

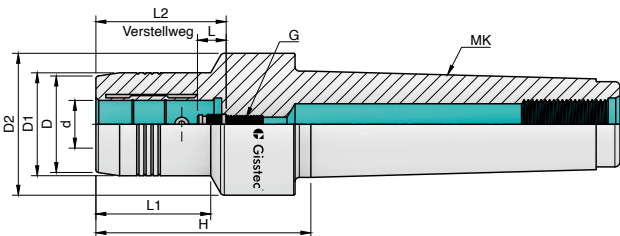

Bestell-Nr. Order No.	Bezeichnung Description	H	d	D	D1	D2	L	L1	L2	G
604.30.120	HMK4 H90 D20	90	20	40	43	50	10	48	42.5	M8X1.0
604.30.132	HMK4 H90 D32	90	32	59	63	72	10	63.5	65	M16x1.0
605.30.120	HMK5 H90 D20	90	20	40	43	60	10	48	42.5	M8X1.25
605.30.132	HMK5 H90 D32	95	32	54	59	63	10	63.5	65	M16x1.0

ISO-7388-1 (DIN69871-SK)

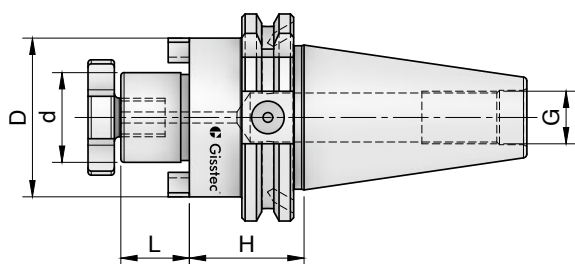

Bestell-Nr. Order No.	Kegel Taper	H	d	D	L	G
140.30.11.116	SK40	35	Ø16	Ø40	17	M16
140.30.11.122	SK40	35	Ø22	Ø48	19	M16
140.30.11.127	SK40	35	Ø27	Ø48	21	M16
140.30.11.132	SK40	50	Ø32	Ø60	24	M16
150.30.11.116	SK50	35	Ø16	Ø40	17	M24
150.30.11.122	SK50	35	Ø22	Ø48	19	M24
150.30.11.127	SK50	35	Ø27	Ø60	21	M24
150.30.11.132	SK50	35	Ø32	Ø78	24	M24
150.30.11.140	SK50	50	Ø40	Ø89	27	M24
150.30.11.160	SK50	80	Ø60	Ø128	50	M24

12164-1 (DIN69893 HSK-A)

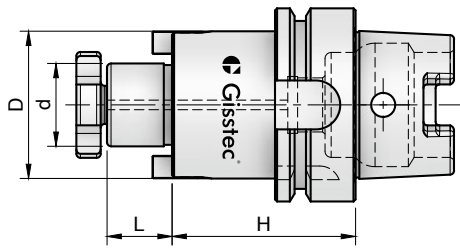

Bestell-Nr. Order No.	Kegel Taper	H	d	D	L
63A.30.11.116	HSKA 63	50	Ø16	Ø40	17
63A.30.11.122	HSKA 63	50	Ø22	Ø48	19
63A.30.11.127	HSKA 63	60	Ø27	Ø60	21
63A.30.11.132	HSKA 63	60	Ø32	Ø78	24
63A.30.11.140	HSKA 63	60	Ø40	Ø89	27
80A.30.11.160	HSKA 80	70	Ø60	Ø128	50
100A.30.11.116	HSKA100	50	Ø16	Ø40	17
100A.30.11.122	HSKA100	50	Ø22	Ø48	19
100A.30.11.127	HSKA100	50	Ø27	Ø60	21
100A.30.11.132	HSKA100	50	Ø32	Ø78	24
100A.30.11.140	HSKA100	60	Ø40	Ø89	27
100A.30.11.160	HSKA100	70	Ø60	Ø128	50
100A.30.11.216	HSKA100	100	Ø16	Ø40	17
100A.30.11.222	HSKA100	100	Ø22	Ø48	19
100A.30.11.227	HSKA100	100	Ø27	Ø60	21
100A.30.11.232	HSKA100	100	Ø32	Ø60	24
100A.30.11.240	HSKA100	100	Ø40	Ø89	27
100A.30.11.360	HSKA100	135	Ø60	Ø130	30

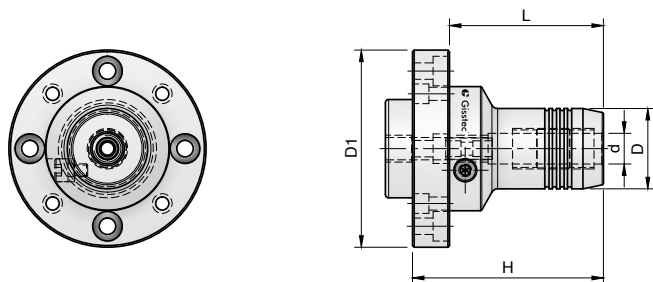

Bestell-Nr. Order No.	H	d	D	D1	L
5.043.240	50	Ø6	Ø26	Ø60	37
5.043.241	50	Ø8	Ø28	Ø60	37
5.043.243	70	Ø10	Ø30	Ø60	57
5.043.244	70	Ø12	Ø32	Ø60	57
5.043.246	70	Ø16	Ø32	Ø60	57
5.043.248	70	Ø20	Ø32	Ø60	57
5.043.253	50	Ø16	Ø38	Ø70	36
5.043.250	82,5	Ø16	Ø38	Ø70	67,5
5.043.254	50	Ø20	Ø41,5	Ø70	36
5.043.252	82,5	Ø20	Ø40	Ø70	67,5
5.043.296	90	Ø10	Ø30	Ø70	75
5.043.267	65	Ø4	Ø22,5	Ø80	50
5.043.268	64,5	Ø6	Ø26,5	Ø80	49,5
5.043.269	77,5	Ø8	Ø28	Ø80	62,5
5.043.242	77,5	Ø10	Ø30	Ø80	62,5
5.043.255	77,5	Ø12	Ø32	Ø80	62,5
5.043.266	82,5	Ø14	Ø34	Ø80	70,5
5.043.256	82,5	Ø16	Ø38	Ø80	67,5
5.043.257	82,5	Ø20	Ø42	Ø80	67,5
5.043.258	90	Ø25	Ø50	Ø80	75
5.043.259	90	Ø12	Ø32	Ø100	66
5.043.264	90	Ø20	Ø50	Ø100	66
5.043.260	100	Ø25	Ø50	Ø100	76
5.043.261	103	Ø32	Ø60	Ø100	79
5.043.265	103	Ø32	Ø60	Ø117	80
5.043.263	110	Ø40	Ø70	Ø117	87

ISO-7388-1 (DIN69871-SK)

Rundlauf
Runout
≤ 0,000 mm

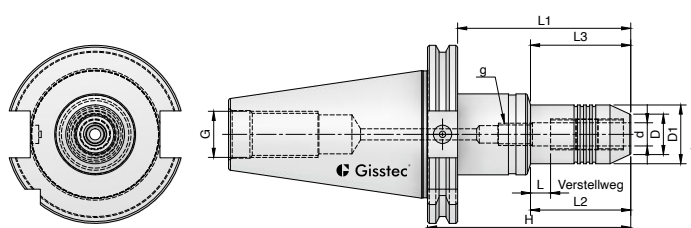

Bestell-Nr. Order No.	Kegel Taper	H	d	D	D1	L	L1	L2	L3	g	G
28.05.043.887	40	115	20	42	86,2	10	95,9	47	52	M12x1	M16
28.05.043.889	40	120	25	42	68,2	10	100,9	35	58	M12x1	M16
28.05.043.890	40	135	32	54	85,16	10	115,9	42	64	M16x1	M16
30.05.043.883	50	110	12	32	43,7	10	90,9	59	47	M10x1	M24
30.05.043.887	50	110	20	42	68,2	10	90,9	47	52	M12x1	M24
30.05.043.889	50	110	25	42	68,2	10	90,9	46	58	M12x1	M24
30.05.043.890	50	110	32	54	85,2	10	90,9	42	64	M16x1	M24

ISO-7388-1 (DIN69871-SK)

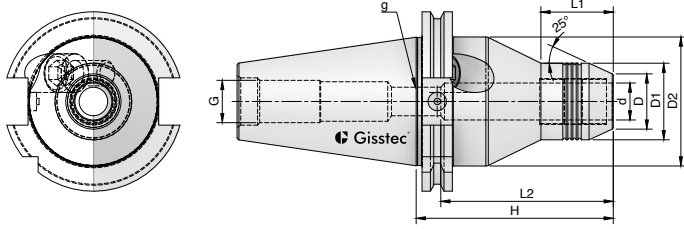

Bestell-Nr. Order No.	Kegel Taper	H	d	D	D1	D2	L1	L2	g	G
28.05.043.901	SK 40	110	20	28	42	50	41	100	M10x1	M16
28.05.043.902	SK 40	110	25	35	50	60	40	80	M10x1	M16
28.05.043.903	SK 40	100	32	41	54	60	56	80	M16x1	M16
30.05.043.925	SK 50	110	6	15	36	60	55	43	M5	M24
30.05.043.926	SK 50	110	8	17	38	60	55	43	M6	M24
30.05.043.927	SK 50	110	10	19	40	60	55	43	M8x1	M24
30.05.043.928	SK 50	110	12	21,5	36,5	60	55	50	M10x1	M24
30.05.043.929	SK 50	110	14	23,5	44	60	60	50	M10x1	M24
30.05.043.900	SK 50	110	16	25,5	46,5	60	60	53	M12x1	M24
30.05.043.930	SK 50	110	18	27,5	48,5	60	60	53	M12x1	M24
30.05.043.901	SK 50	110	20	29	42	70	41	95	M16x1	M24
30.05.043.903	SK 50	110	22	30	44	70	43	95	M16x1	M24
30.05.043.902	SK 50	110	32	41	54	70	56	85	M16x1	M24
30.05.043.904	SK 50	130	40	52	70	70	110,9	115	M16x1	M24

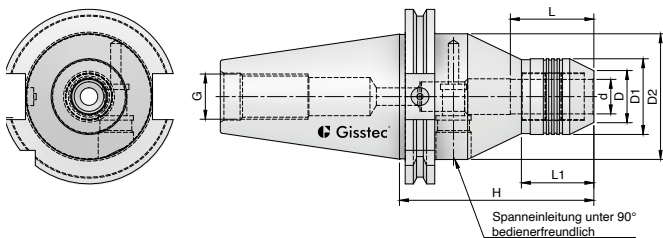

Bestell-Nr. Order No.	Kegel Taper	H	d	D	D1	L	L1	G
30.05.043.960	SK 50	165	20	29	42	110	41	M24
30.05.043.961	SK 50	165	22	31	44	110	42	M24
30.05.043.962	SK 50	160	25	34	46	110	42	M24
30.05.043.963	SK 50	160	32	42	54	110	46	M24

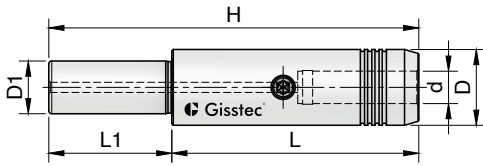

Bestell-Nr. Order No.	H	D1	d	D	L	L1
612.30.212	146	Ø12	Ø12	Ø25	100	46
620.30.212	150	Ø20	Ø12	Ø25	100	50
620.30.216	150	Ø20	Ø16	Ø28	100	50
620.30.220	150	Ø20	Ø20	Ø32	100	50
622.30.112	132,5	Ø22	Ø12	Ø32	62,5	70
632.30.312	200	Ø32	Ø12	Ø25	140	60
632.30.316	200	Ø32	Ø16	Ø28	140	60
632.30.320	200	Ø32	Ø20	Ø32	140	60

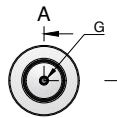
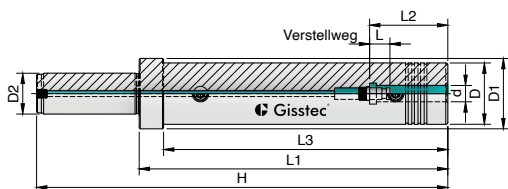

Bestell-Nr. Order No.	H	d	D	D2	D1	L	L1	L2	L3	G
612.30.406	200	6	28	12	34	10	150	37.5	138	M5X0.8
612.30.408	200	8	30	12	34	10	150	37.5	138	M6X1.0
612.30.410	200	10	32	12	34	10	150	42.5	138	M6X1.0
612.30.412	200	12	-	12	34	10	150	47.5	138	M6X1.0
620.30.406	200	6	28	20	34	10	150	37.5	138	M5X0.8
620.30.408	200	8	30	20	34	10	150	37.5	138	M6X1.0
620.30.410	200	10	32	20	34	10	150	42.5	138	M6X1.0
620.30.412	200	12	-	20	34	10	150	47.5	138	M6X1.0
632.30.406	200	6	28	32	34	10	150	37.5	138	M5X0.8
632.30.408	200	8	30	32	34	10	150	37.5	138	M6X1.0
632.30.410	200	10	32	32	34	10	150	42.5	138	M6X1.0
632.30.412	200	12	-	32	34	10	150	47.5	138	M6X1.0

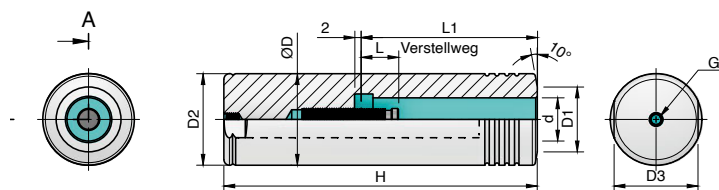

Bestell-Nr. Order No.	H	d	D	D1	D2	D3	L	L1	G
622.30.204	110	4	22	11	21.85	20	-	28	-
622.30.206	110	6	22	14	21.85	20	10	37.5	M5X0.8
622.30.208	110	8	22	16	21.85	20	10	37.5	M6X1.0
622.30.210	110	10	22	28	21.85	20	10	42.5	M6X1.0

Bestell-Nr. Order No.	H	d	D	D1	D2	D3	L	L1	G
625.30.204	110	4	25	11	24.85	23	10	28	-
625.30.206	110	6	25	14	24.85	23	10	37.5	M5X0.8
625.30.208	110	8	25	16	24.85	23	10	37.5	M6X1.0
625.30.210	110	10	25	10	24.85	23	10	42.5	M6X1.0
625.30.212	110	12	25	12	24.85	23	10	47.5	M6X1.0

Bestell-Nr. Order No.	H	d	D	D1	D2	D3	L	L1	G
632.30.204	110	4	32	11	31.85	30	-	28	-
632.30.206	110	6	32	14	31.85	30	10	37.5	M5X0.8
632.30.208	110	8	32	16	31.85	30	10	37.5	M6X1.0
632.30.210	110	10	32	18	31.85	30	10	42.5	M6X1.0
632.30.212	110	12	32	22	31.85	30	10	47.5	M6X1.0

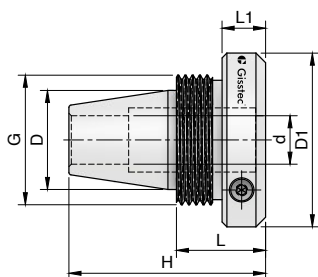

Bestell-Nr. Order No.	D	G	H	d	D1	L	L1
426.30.105	ER16	M24 x 1,0	43,7	5	36	22,5	11,5
426.30.106	ER16	M24 x 1,0	45,7	6	36	24,5	13,5
426.30.108	ER16	M24 x 1,0	45,7	8	36	24,5	13,5
428.30.106	ER20	M28 x 1,5	48,3	6	38	24	13
428.30.108	ER20	M28 x 1,5	48,3	8	38	24	13
428.30.110	ER20	M28 x 1,5	48,3	10	40	24	13
430.30.105	ER25	M32 x 1,5	51	5	40	24,5	12
430.30.106	ER25	M32 x 1,5	51	6	40	24,5	12
430.30.108	ER25	M32 x 1,5	51	8	40	24,5	12
430.30.110	ER25	M32 x 1,5	51	10	40	24,5	12
430.30.112	ER25	M32 x 1,5	51	12	42	24,5	12
430.30.114	ER25	M32 x 1,5	51	14	44	24,5	12
430.30.116	ER25	M32 x 1,5	49	16	46	26,5	14
470.30.106	ER32	M40 x 1,5	58,3	6	50	26,5	12
470.30.108	ER32	M40 x 1,5	58,3	8	50	26,5	12
470.30.110	ER32	M40 x 1,5	58,3	10	50	26,5	12
470.30.112	ER32	M40 x 1,5	58,3	12	50	26,5	12
470.30.114	ER32	M40 x 1,5	58,3	14	50	26,5	12
470.30.116	ER32	M40 x 1,5	58,3	16	50	26,5	12
470.30.118	ER32	M40 x 1,5	58,3	18	50	26,5	12
470.30.120	ER32	M40 x 1,5	58,3	20	50	26,5	12
472.30.116	ER40	M50 x 1,5	72	16	63	36,5	20,5
472.30.120	ER40	M50 x 1,5	72	20	63	36,5	20,5
472.30.125	ER40	M50 x 1,5	72	25	63	36,5	20,5

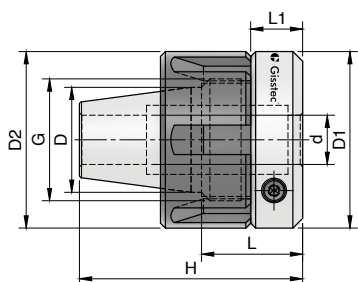

Bestell-Nr. Order No.	D	G	H	d	D1	L	L1
426.30.205	ER16	M22 x 1,0	43,7	5	36	22,5	12
426.30.206	ER16	M22 x 1,0	45,7	6	36	24,5	14
426.30.208	ER16	M22 x 1,0	45,7	8	36	24,5	14
428.30.206	ER20	M25 x 1,5	48,3	6	38	24	13,5
428.30.208	ER20	M25 x 1,5	48,3	8	38	24	13,5
428.30.210	ER20	M25 x 1,5	48,3	10	38	24	13,5
430.30.206	ER25	M32 x 1,5	51	6	40	24,5	12
430.30.208	ER25	M32 x 1,5	51	8	40	24,5	12
430.30.210	ER25	M32 x 1,5	51	10	40	24,5	12
430.30.212	ER25	M32 x 1,5	51	12	42	24,5	12
430.30.214	ER25	M32 x 1,5	51	14	44	24,5	12
430.30.216	ER25	M32 x 1,5	49	16	46	26,5	14
470.30.206	ER32	M40 x 1,5	58,3	6	50	26,5	12
470.30.208	ER32	M40 x 1,5	58,3	8	50	26,5	12
470.30.210	ER32	M40 x 1,5	58,3	10	50	26,5	12
470.30.212	ER32	M40 x 1,5	58,3	12	50	26,5	12
470.30.214	ER32	M40 x 1,5	58,3	14	50	26,5	12
470.30.216	ER32	M40 x 1,5	58,3	16	50	26,5	12
470.30.218	ER32	M40 x 1,5	58,3	18	50	26,5	12
470.30.220	ER32	M40 x 1,5	58,3	20	50	26,5	12
472.30.216	ER40	M50 x 1,5	72	16	63	36,5	20,5
472.30.220	ER40	M50 x 1,5	72	20	63	36,5	20,5
472.30.225	ER40	M50 x 1,5	72	25	63	36,5	20,5

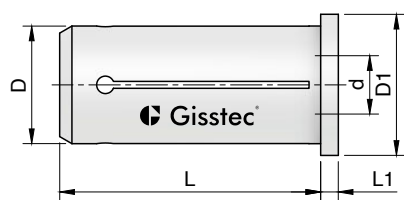

Bestell-Nr. Order No.	d	D	D1	L	L1
412.30.03.IK	3	12	16.5	45	2
412.30.04.IK	4	12	16.5	45	2
412.30.05.IK	5	12	16.5	45	2
412.30.06.IK	6	12	16.5	45	2
412.30.08.IK	8	12	16.5	45	2
420.30.03.IK	3	20	24	50	2
420.30.04.IK	4	20	24	50	2
420.30.05.IK	5	20	24	50	2
420.30.06.IK	6	20	24	50	2
420.30.08.IK	8	20	24	50	2
420.30.10.IK	10	20	24	50	2
420.30.12.IK	12	20	24	50	2
420.30.16.IK	16	20	24	50	2
432.30.06.IK	6	32	35.5	60	3
432.30.08.IK	8	32	35.5	60	3
432.30.10.IK	10	32	35.5	60	3
432.30.12.IK	12	32	35.5	60	3
432.30.16.IK	16	32	35.5	60	3
432.30.20.IK	20	32	35.5	60	3
432.30.25.IK	25	32	35.5	60	3

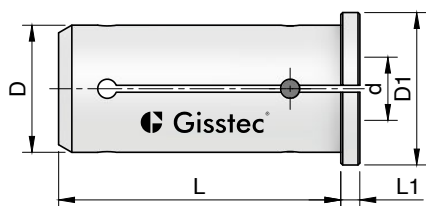

Bestell-Nr. Order No.	d	D	D1	L	L1
412.30.03	3	12	16	44	2
412.30.04	4	12	16	44	2
412.30.05	5	12	16	44	2
412.30.06	6	12	16	44	2
412.30.08	8	12	16	44	2
420.30.03	3	20	24	50	2
420.30.04	4	20	24	50	2
420.30.05	5	20	24	50	2
420.30.06	6	20	24	50	2
420.30.08	8	20	24	50	2
420.30.10	10	20	24	50	2
420.30.12	12	20	24	50	2
420.30.14	14	20	24	50	2
420.30.16	16	20	24	50	2
432.30.06	6	32	36	60	3
432.30.08	8	32	36	60	3
432.30.10	10	32	36	60	3
432.30.12	12	32	36	60	3
432.30.16	16	32	36	60	3
432.30.18	18	32	36	60	3
432.30.20	20	32	36	60	3
432.30.25	25	32	36	60	3

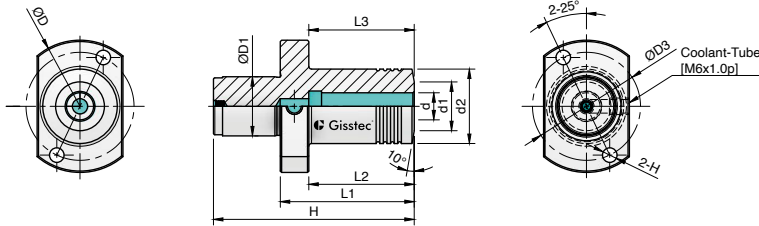

Bestell-Nr. Order No.	H	D	D1	D3	d	d1	d2	L1	L2	L3	L4	H	Machinen-Typ Machine Type
622.30.106.F	75	49	22	40	6	13	23	50	40	39.5	28	5.6	Star
622.30.108.F	75	49	22	40	8	16	26	50	40	39.5	30	5.6	Star
622.30.110.F	75	49	22	40	10	18	28	50	40	39.5	32	5.6	Star
622.30.112.F	75	49	22	40	12	19	29	50	40	39.5	34.5	5.6	Star

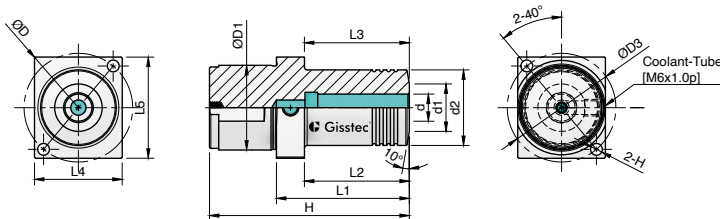

Bestell-Nr. Order No.	H	D	D1	D3	d	d1	d2	L1	L2	L3	L4	L5	H	Machinen-Typ Machine Type
632.30.206.F	75	49	32	39.5	6	13	23	50	40	39.5	32.5	37.5	4.5	Star
632.30.208.F	75	49	32	39.5	8	16	26	50	40	39.5	32.5	37.5	4.5	Star
632.30.210.F	75	49	32	39.5	10	18	28	50	40	39.5	32.5	37.5	4.5	Star
632.30.212.F	75	49	32	39.5	12	19	29	50	40	39.5	32.5	37.5	4.5	Star

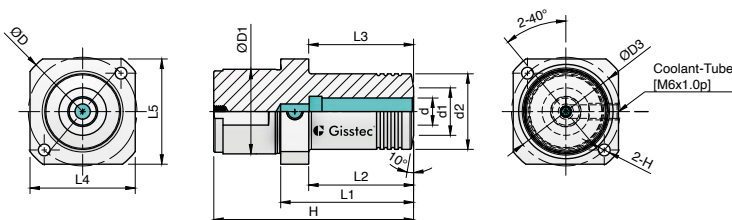

Bestell-Nr. Order No.	H	D	D1	D3	d	d1	d2	L1	L2	L3	L4	H	Machinen-Typ Machine Type
632.30.306.F	75	49	32	39.5	6	13	23	50	40	39.5	39	4.5	Hanwha
632.30.308.F	75	49	32	39.5	8	16	26	50	40	39.5	39	4.5	Hanwha
632.30.310.F	75	49	32	39.5	10	18	28	50	40	39.5	39	4.5	Hanwha
632.30.312.F	75	49	32	39.5	12	19	29	50	40	39.5	39	4.5	Hanwha



Gisstec GmbH

Fertigung / Factory
Daimlerstr. 8
72818 Trochtelfingen
Germany

Showroom | Vertrieb | Logistik
Steinbeisstr. 12
73730 Esslingen am Neckar
Germany

+49 7124 3849 890
info@gisstec.com
www.gisstec.com